

UK Picnic Benches

Thank you for purchasing one of our picnic benches. Each bench is individually handmade and designed to last for many years. Every bench is fully assembled, checked and hand packed prior to dispatch, however we recommend before assembling your new bench, you take a few moments to familiarise yourself with the parts supplied and also ensure that there are no items missing from the package.

Parts List:

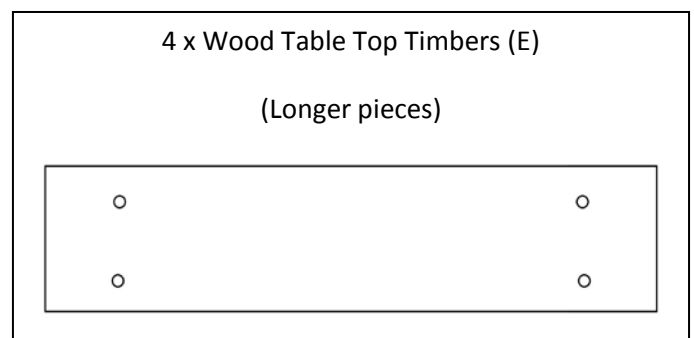
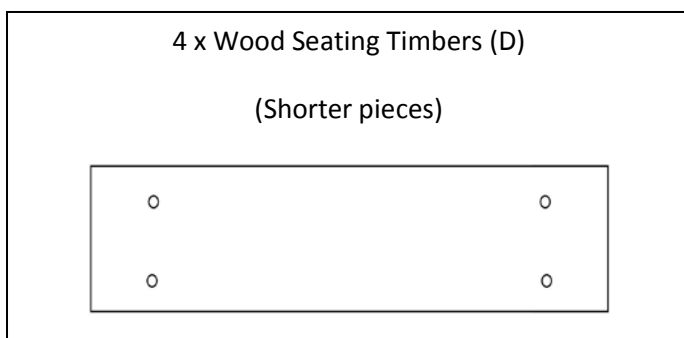
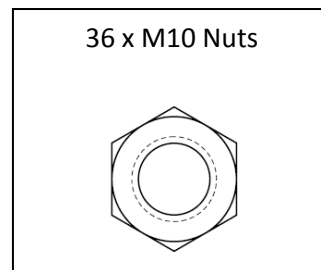
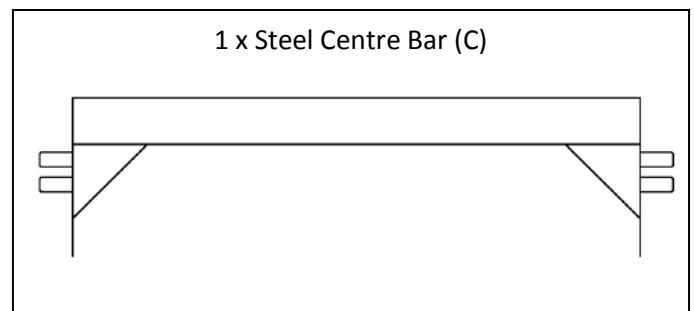
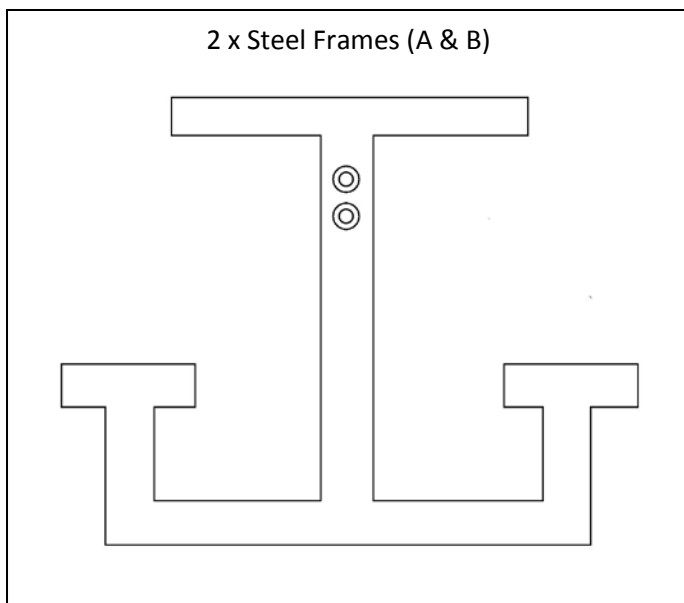

Tools Required:

17mm socket with short extension bar
and wrench

Hammer or mallet



Look out for me – I can tell you a useful hint or tip

Assembly Instructions

1 Lay part **C** on the floor with the end pieces pointing upwards. Assemble part **A** to **C** using 2 of the M10 nuts, tighten securely but do not over tighten. The larger holes in parts **A** should face outwards to allow access to the securing nuts.



To prevent dropping the nuts inside the steel framework, attach the extension bar to the socket then put the nut in your socket using this to pass through the hole.

2 With parts **A** & **C** assembled, loosely assemble part **B** to the other end of part **C** in the same manner as before. DO NOT tighten fully as this is to allow some movement while attaching the wooden parts.

3 Turn the complete assembly over so that it is standing upright in the correct orientation.

4 Starting with the table top lay the four table timbers (parts **D**) in position. Working from the end of the bench that was secured in section 1, place a coach bolt in each of the holes in the wooden parts and align with the holes in the steel framework. Drive each coach bolt into the wood with a hammer. If you wish, you may place a nut loosely on each coach bolt, but do NOT tighten at this stage.



Although the benches have been designed to have shorter seats than table top, it is perfectly feasible to swap the timbers around to give a shorter table top and longer seat as you prefer. If it is decided to have longer seats then caution should be exercised when sitting at the very ends.

5 Lay two of the remaining four timbers on one of the seat supports and fit with coach bolts using the same method as in step 4. Repeat with the final two timbers and seat support. Again, if you wish you may loosely fit the nuts.

6 Working at the other end of the bench place a coach bolt through each of the holes in the wooden parts aligning the holes in the steel framework which, if left slightly loose as described in step 2, should allow more than sufficient movement. Once all holes are aligned drive the bolts into the wood with a hammer and fully tighten parts **B** & **C**.

7 Using the M10 nuts secure the seats and table top to the steel framework. Do not over tighten.



Remember the hint in step 1 to prevent losing nuts? Use this method again to fit the nuts from below; it's a lot easier to put the nuts onto the bolts this way.

8 Fit the 36 round caps followed by the 16 square caps into place to finish the holes in the steel framework by gently tapping the caps into place using a hammer or rubber mallet.



A small piece (approx 3-4mm) may need to be trimmed from one of the inside edges of some square caps to prevent fouling inside the framework.

9 Enjoy your new picnic bench.